

Location Plan



Local Development Plan Provisions

1.0 GENERAL PROVISIONS

1.1 The requirements of the City of Wanneroo District Planning Scheme No. 2, the Residential Design Codes (R-Codes) and Local Planning Policy 4.19: Medium-Density Housing Standards (RMD-Codes) apply, unless otherwise provided below.

2.0 RESIDENTIAL DESIGN CODE AND ZONE

LOTS APPLICABLE	R-CODE DENSITY AND ZONING
Lots 2436-2461	RMD30
Lots 2488-2489, 2649, 2664	RMD40
Lots 2486-2487, 2627-2628, 2645-2646	RMD60

3.0 DEVELOPMENT STANDARDS

3.1 For Lots 2436, 2488, 2489, 2450, 2451, 2454, 2455 & 2457 garage locations are to be provided as shown on the LDP.

Legend

Extent of Local Development Plan	Retaining Walls (by developer)
Primary Dwelling Orientation	Designated Garage Location
Secondary Dwelling Orientation	Preferred Garage Location
	Bin Presentation pads for Lots 2455 & 2456

Endorsement Table

This Local Development Plan has been approved by Council under Clause 52(1)(a) of the Deemed Provisions of District Planning Scheme No. 2

Manager, Approval Services _____
City of Wanneroo

Date: _____

Local Development Plan - Aura Stage 34A

TRINITY ESTATE ALKIMOS

A Northern Corridor Developments Ltd Project

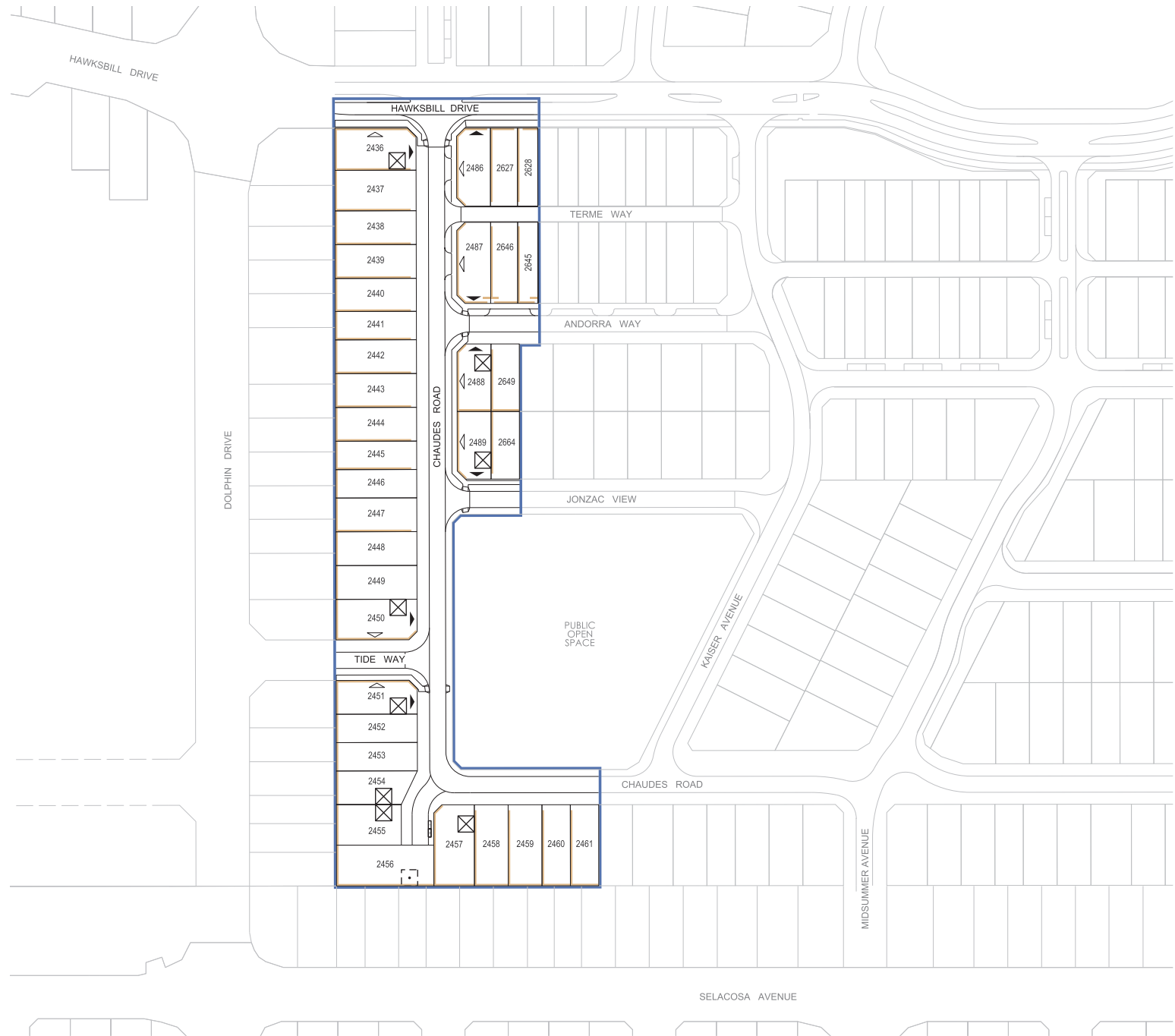

DRAFT

	plan: 20/12/047B	date: 27/01/2022	designed: KS
scale: 1:1500@A3 1:750@A1	grd: PCG 94	checked: KS	drawn: CR
0 15 30m	aerial: -		